

Monomando para Regadera Deco / Deco Shower Single Control

MOR-DC-01

NB

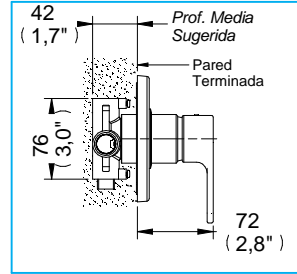
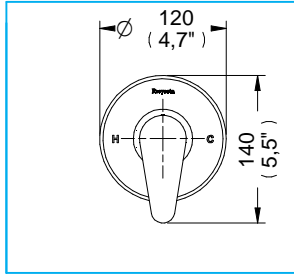

Medidas Referenciales / Estimated Dimensions, Acot.mm.(pulg) / Dim.mm.(in)

Características y Datos Técnicos / Characteristics and Technical Details

Cartucho Cerámico para Monomando con Barreno Pasado

Single Control with Ceramic Cartridge to Passed Hole

Material:
Latón

Material:
Brass

Conexión:
1/2" -14 NPT

Inlet thread:
1/2" -14 NPSM

Ajuste de Instalación:
25,4 mm (1") Max.

Adjustment of Installation:
25,4 mm (1") Max.

Presión de Trabajo:
Pmin= 0,25 kg/cm² (3,55 PSI)
Pmax= 6,0 kg/cm² (85,34 PSI)

Working Pressure:
Pmin= 0,25 kg/cm² (3,55 PSI)
Pmax= 6,0 kg/cm² (85,34 PSI)

Despiece / Components

| Mod. | Descripción | Mod. | Description |
|------|--|------|--|
| 1 | Pr2-085 Tapón Macho Cuerpo Duplex | 1 | Pr2-085 Duplex Body Male Cap |
| 2 | PS2-1221 Cartucho para Monomando | 2 | PS2-1221 Single Control Cartridge |
| 3 | Pr2-613 Tuerca 1-1/2" 24 UNS-2A | 3 | Pr2-613 1-1/2" 24 UNS-2A Nut |
| 4 | Pr2-612 Chapetón 1-1/8" | 4 | Pr2-612 1-1/8" Escutcheon |
| 5 | Pr5-1465 Empaque Sello p/ Chapetón Hotelera | 5 | Pr5-1465 Hotel Escutcheon Cover Gasket |
| 6 | Pr5-1431 Soporte para Empaque y Chapetón | 6 | Pr5-1431 Escutcheon Gasket Support |
| 7 | Pr5-407 Sello Neopreno p/ Cubre Tornillo | 7 | Pr5-407 Neoprene Seal for Screw Cover |
| 8 | Pr5-431 Llave Allen 5/64" | 8 | Pr5-431 5/64" Allen Wrench |
| 9 | Pr2-2670 Opresor Allen 8-32 UNC x 1 1/16" Long | 9 | Pr2-2670 Oppressor Allen 8-32 UNC x 1 1/16" Long |
| | Sub-ensamble | | Sub-assembly |
| 10 | Ps2-1058 Maneral Armado Integra p/Monomando | 10 | PS2-1058 Armed Handle Integra p/ Mixer |
| 11 | Ps5-622 Chapetón Monomando Deco c/ Empaques | 26 | PS5-622 Deco Single Handle Flange w /Gasket |

* Los productos ilustrados pueden sufrir cambios sin previo aviso en su aspecto o partes, como resultado de los procesos de mejora continua al que están sujetos, sin implicar mayor responsabilidad de la fábrica.

* Products depicted here in subject to change without prior notice in their appearance or components as a result of incremental innovation.

